

CONBRACO 40-500 SERIES

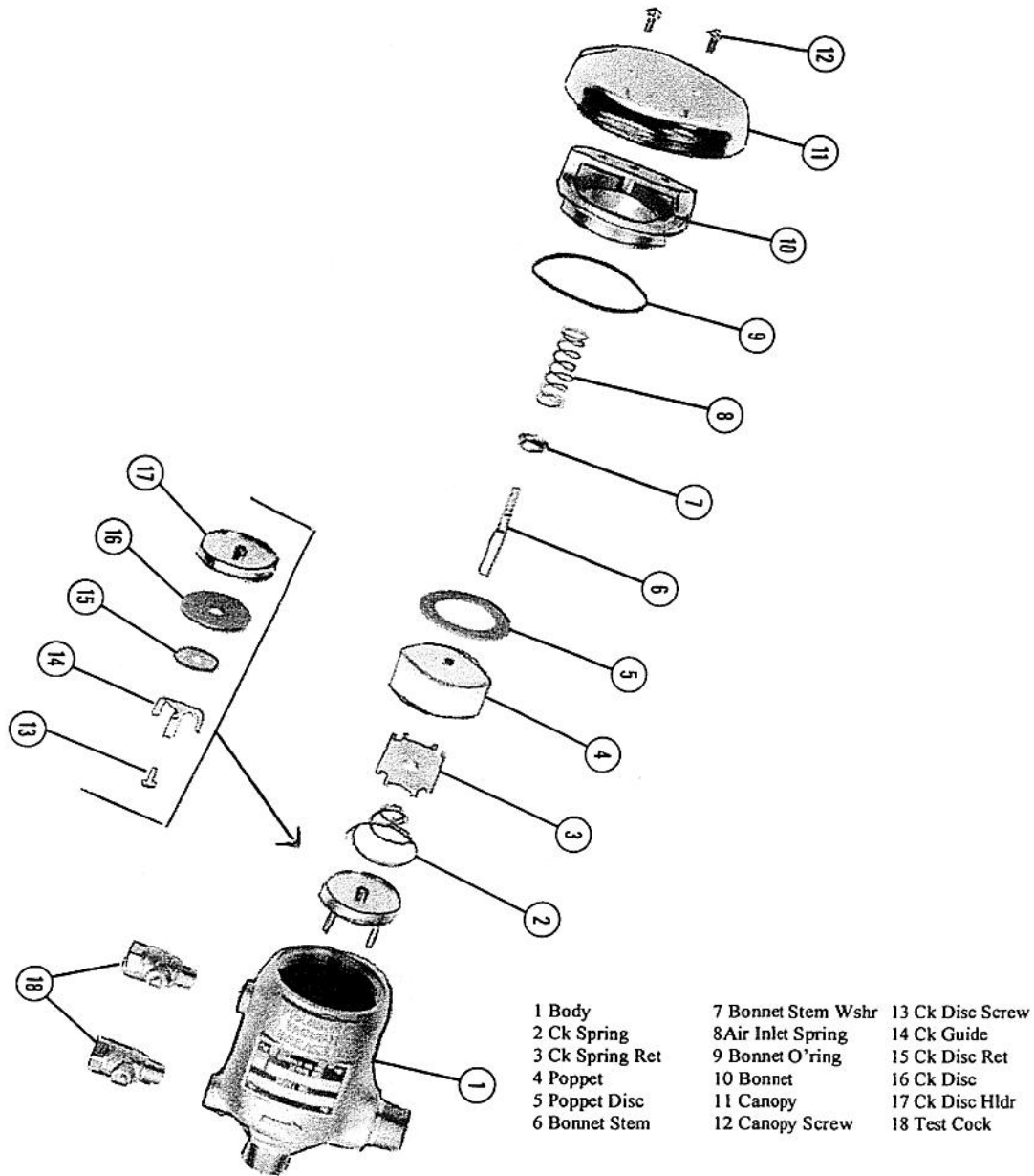



SERIES 40-500

1/2" – 2"

Pressure Type Vacuum Breaker

MAINTENANCE

A. DISASSEMBLY

1. Close No. 2 shut-off valve, then close No. 1 shut-off valve.
2. Bleed pressure from device by opening test cocks #1 and #2.
3. Remove the air inlet canopy.
4. Unscrew and remove the cap and float being careful not to damage sealing edge on underside of cap. Inspect float seat for damage or fouling debris.
NOTE: Float guide stem is held in cap with high strength thread adhesive—do not remove unless necessary and a replacement stem is available.
5. Remove check spring retainer by pressing down and rotating to clear tabs on body.
6. Remove spring and check assembly. Inspect seat edge in body for damage or fouling debris.

7. Inspect seat disc for damage or fouling debris. If disassembly is necessary be careful not to bend the guide legs.

B. ASSEMBLY

1. Rinse all parts in clean water prior to assembly.
2. Reassemble check assembly if necessary.
NOTE: Tighten seat retaining screw until just snug—overtightening may bend the guide legs and cause the check to drag in the body.
3. Carefully place the check assembly in the body with the guide legs inside the inlet bore. Check for free movement of the assembly.
4. Place large end of spring down into check assembly.
5. Place spring retainer with center boss facing spring into body. Press down and rotate retainer to line up ears with tabs in body and lock into position.
6. Place float seat disc into groove of float.
7. NOTE: If guide stem was removed the thread engagement of the new stem must be gaged. Screw the stem into the cap until a gap of approximately $\frac{3}{32}$ " between the float disc and the cap is achieved when the float rests against the spring washer.
8. Apply a thin coat of silicone based lubricant to the cap o-ring.
9. Place float inside body and lower cap carefully into body being sure guide stem is inserted into center of float and tighten cap.
10. Test device to ensure proper operation.
11. Apply thread adhesive to center hole in top of cap.
12. Install inlet canopy.